



VIVEKANAND VIDYA ASHRAM SANSTHA VILLAGE - KATAR CHHOTI TH- BIDASAR

Sr. No. 29731

(CHURU) KHASARA NO- 504 505 568
500,500,488

Date- 24.03.2026

TOTAL LAND AREA :- 17710 SQM.
(4-YEAR INTEGRATED + B.ED- 7590)+ (DEGREE COLLEGE -10120)
TOTAL BUILTUP AREA:- 7367 SQM.
(4-YEAR INTEGRATED + B.ED- 3750) + (DEGREE COLLEGE -3617)

NOKHA JAIPUR ROAD SH-20

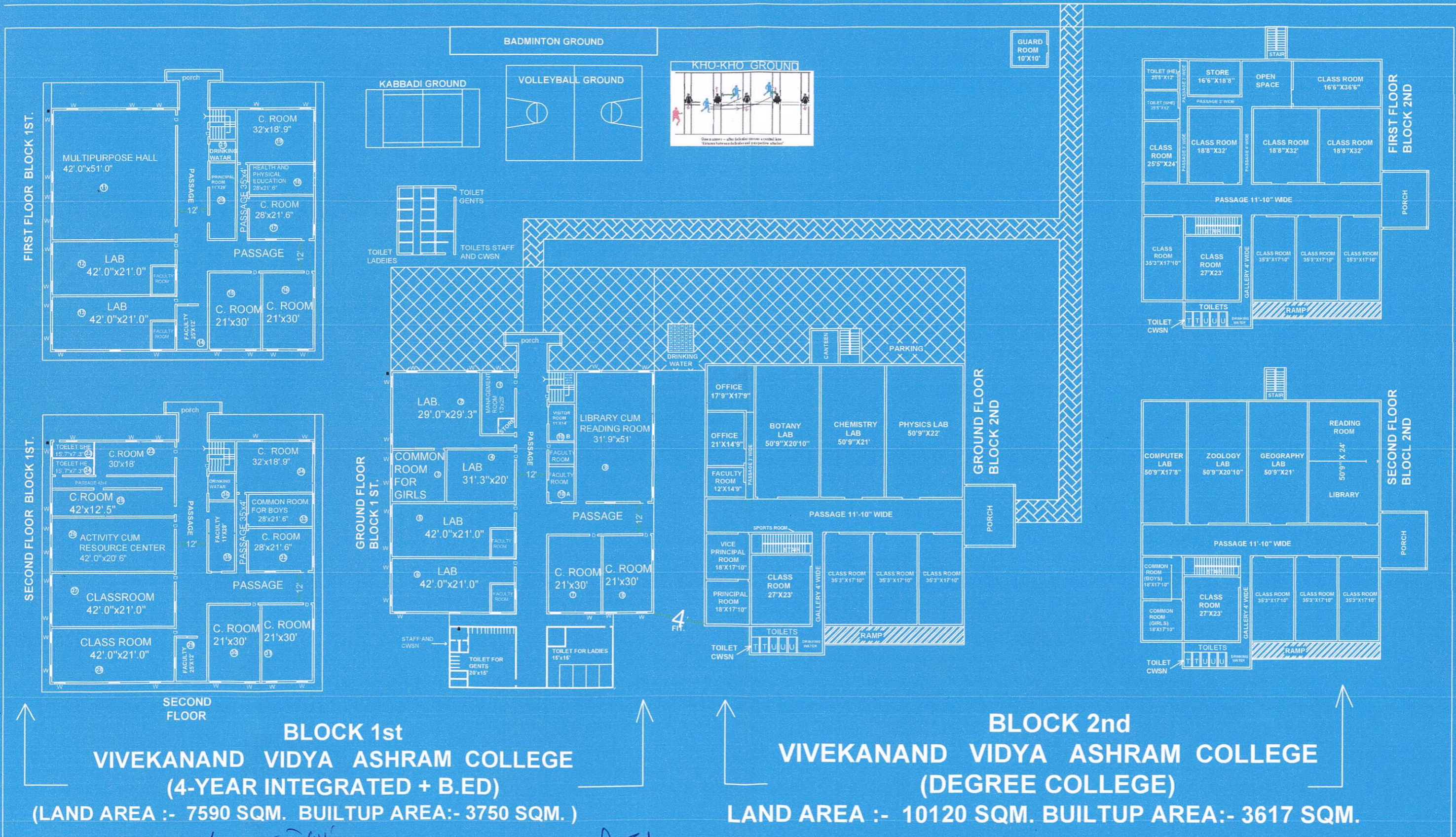

BLOCK 1st
VIVEKANAND VIDYA ASHRAM COLLEGE
(4-YEAR INTEGRATED + B.ED)
(LAND AREA :- 7590 SQM. BUILTUP AREA:- 3750 SQM.)

BLOCK 2nd
VIVEKANAND VIDYA ASHRAM COLLEGE
(DEGREE COLLEGE)
LAND AREA :- 10120 SQM. BUILTUP AREA:- 3617 SQM.

Secretary
 Vivekanand Vidya Ashram Sanstha
 Katar Chhoti, Bidasar (Churu)

JE
 161यक समिती
 नि.वि.उपखण्ड
 बीदासर(चुरु)

ग्राम पंचायत कतर छोटी
 (पं.स.बीदासर(चुरु))